



FOR LEASE  
**Somersville Town Center**  
 2550 Somersville Road, Antioch, CA



**PROPERTY PROFILE**

Size: ±49,412 SF (Divisible to ±20,000 SF)

Price: Please Contact Broker for Pricing

**PROPERTY HIGHLIGHTS**

- Anchor space adjacent to brand new 24 Hour Fitness club
- High ceilings which can support any use
- Regional accessibility
- Ample parking

**DEMOGRAPHICS**

	1-mile	2-mile	3-mile
<b>Population</b>	16,793	50,772	86,274
<b>Daytime Population</b>	11,710	22,049	32,759
<b>Median HHI</b>	\$42,069	\$51,775	\$52,551

**DEMOGRAPHICS**

Hwy 4 at Somersville Rd. 241,000 ADT  
 Somersville Rd. at Buchanan Rd. 30,940 ADT

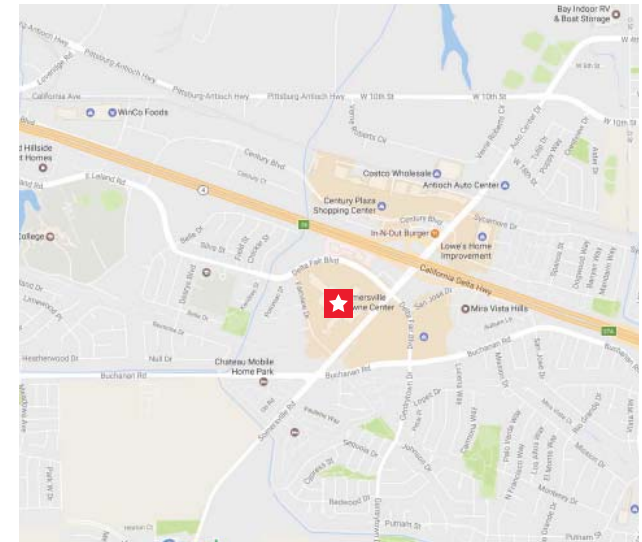

**James Chung**  
 Executive Managing Director  
 Managing Principal, West Region Retail  
 +1 408 436 3630  
 james.chung@cushwake.com  
 LIC #01408190

**Mike Costa**  
 Senior Director  
 +1 408 436 3660  
 mike.costa@cushwake.com  
 LIC #00415216

300 Santana Row, Fifth Floor  
 San Jose, CA 95128  
 main +1 408 615 3400  
 fax +1 408 615 4444  
**cushmanwakefield.com**

Cushman & Wakefield Copyright 2017. No warranty or representation, express or implied, is made to the accuracy or completeness of the information contained herein, and same is submitted subject to errors, omissions, change of price, rental or other conditions, withdrawal without notice, and to any special listing conditions imposed by the property owner(s). As applicable, we make no representation as to the condition of the property (or properties) in question.

**SPACE PLAN OPTION 1**

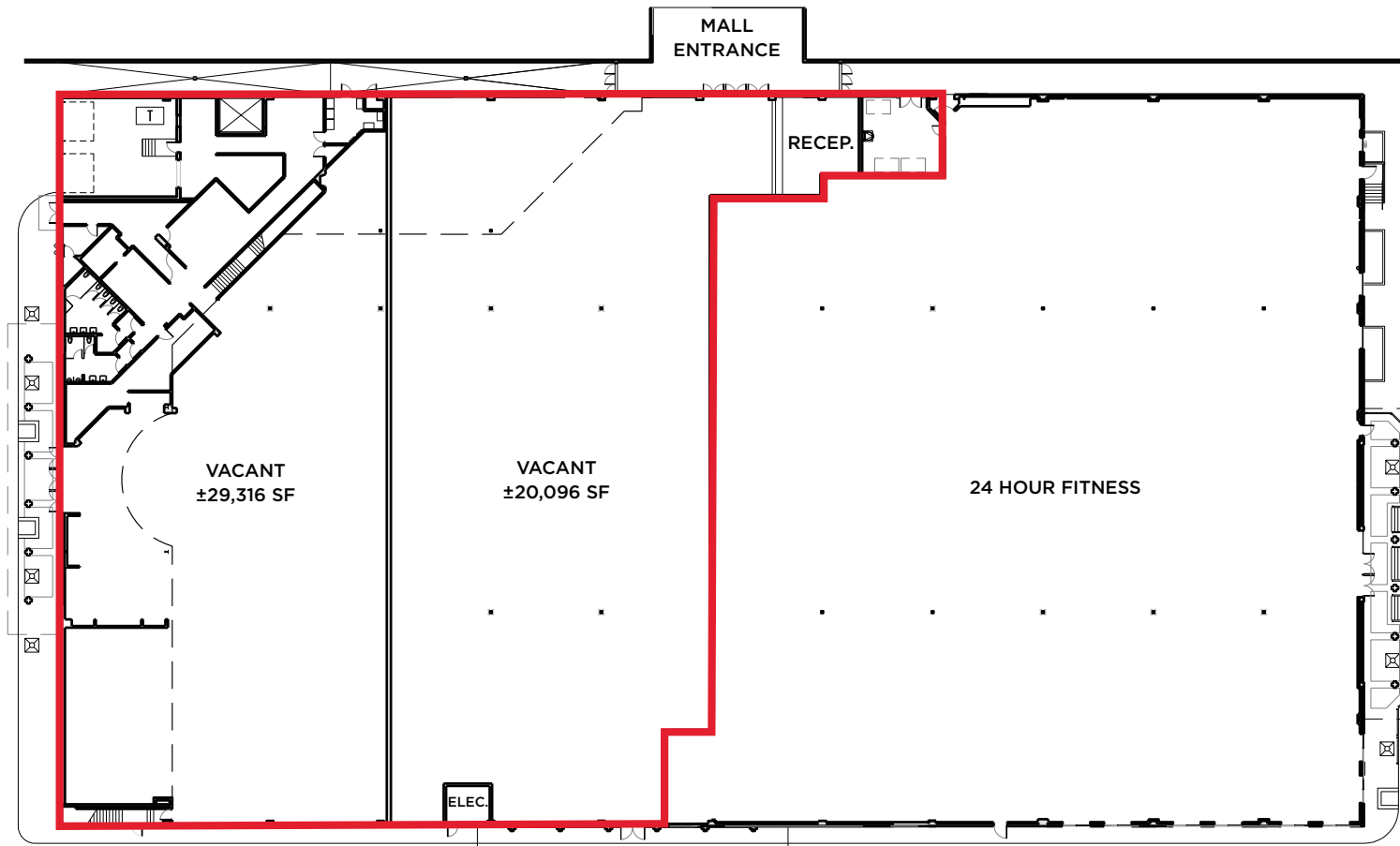

**James Chung**  
Executive Managing Director  
Managing Principal, West Region Retail  
+1 408 436 3630  
james.chung@cushwake.com  
LIC #01408190

**Mike Costa**  
Senior Director  
+1 408 436 3660  
mike.costa@cushwake.com  
LIC #00415216

300 Santana Row, Fifth Floor  
San Jose, CA 95128  
main +1 408 615 3400  
fax +1 408 615 4444  
**cushmanwakefield.com**

**SPACE PLAN OPTION 2**

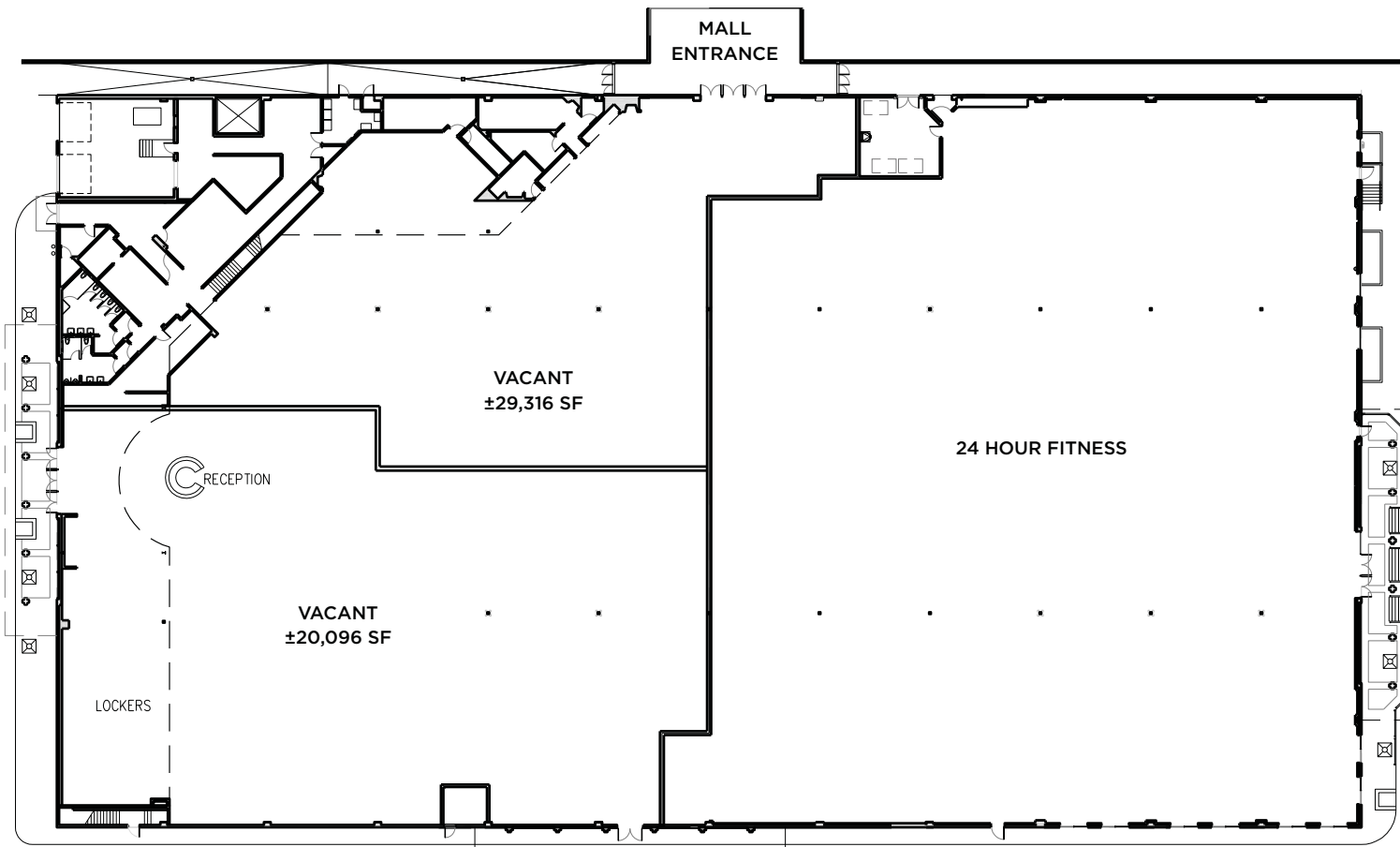

**James Chung**  
Executive Managing Director  
Managing Principal, West Region Retail  
+1 408 436 3630  
james.chung@cushwake.com  
LIC #01408190

**Mike Costa**  
Senior Director  
+1 408 436 3660  
mike.costa@cushwake.com  
LIC #00415216

**SPACE PLAN OPTION 3**

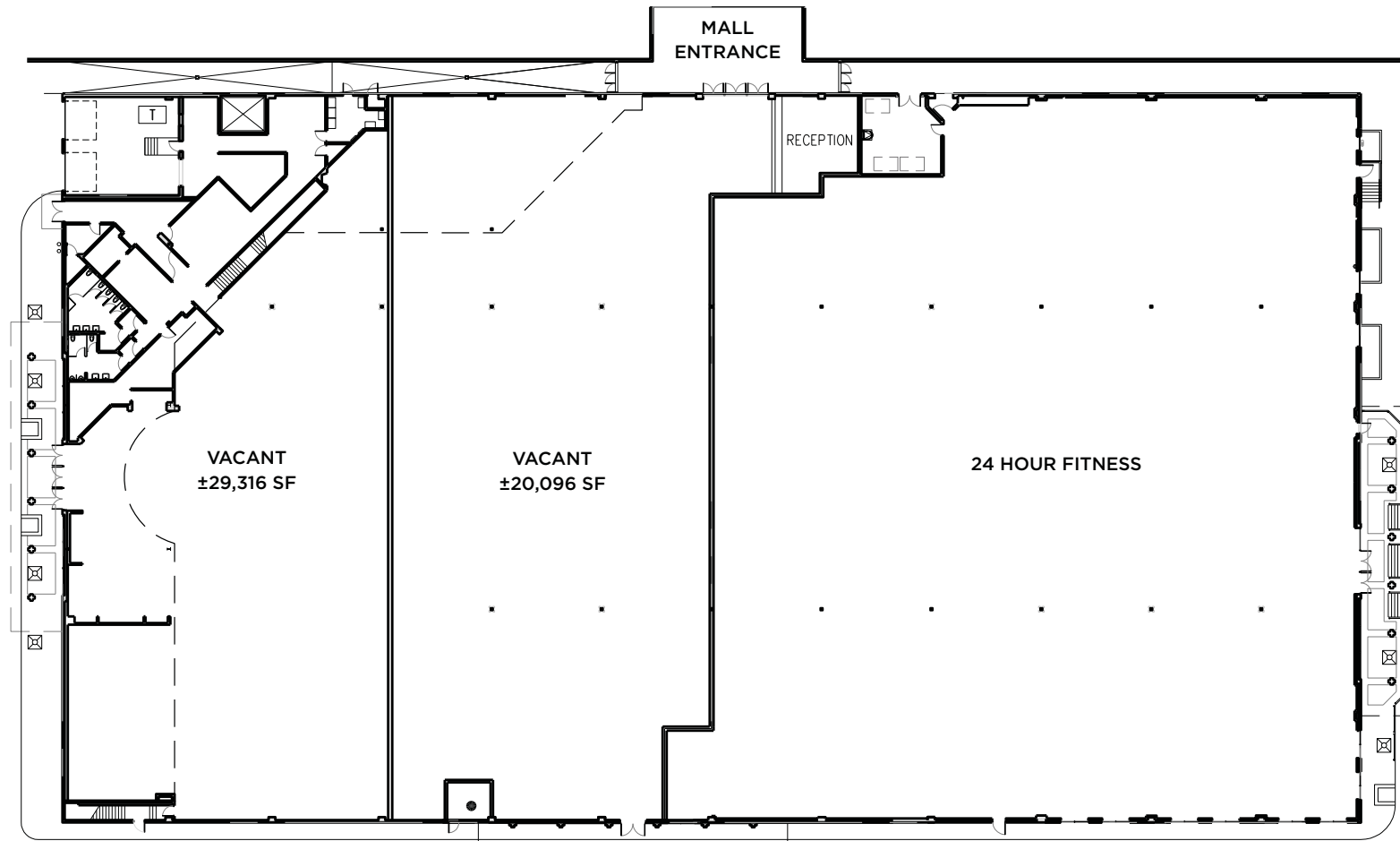

**James Chung**  
Executive Managing Director  
Managing Principal, West Region Retail  
+1 408 436 3630  
james.chung@cushwake.com  
LIC #01408190

**Mike Costa**  
Senior Director  
+1 408 436 3660  
mike.costa@cushwake.com  
LIC #00415216

300 Santana Row, Fifth Floor  
San Jose, CA 95128  
main +1 408 615 3400  
fax +1 408 615 4444  
[cushmanwakefield.com](http://cushmanwakefield.com)

**2 MILE MARKET AERIAL**



**James Chung**  
 Executive Managing Director  
 Managing Principal, West Region Retail  
 +1 408 436 3630  
 james.chung@cushwake.com  
 LIC #01408190

**Mike Costa**  
 Senior Director  
 +1 408 436 3660  
 mike.costa@cushwake.com  
 LIC #00415216

300 Santana Row, Fifth Floor  
 San Jose, CA 95128  
 main +1 408 615 3400  
 fax +1 408 615 4444  
**cushmanwakefield.com**

**MARKET AERIAL**



**James Chung**  
 Executive Managing Director  
 Managing Principal, West Region Retail  
 +1 408 436 3630  
 james.chung@cushwake.com  
 LIC #01408190

**Mike Costa**  
 Senior Director  
 +1 408 436 3660  
 mike.costa@cushwake.com  
 LIC #00415216

300 Santana Row, Fifth Floor  
 San Jose, CA 95128  
 main +1 408 615 3400  
 fax +1 408 615 4444  
**cushmanwakefield.com**